

MOBY DICK sospensione

Matteo Ugoloni design

anno 2013

SCHEDA TECNICA - SE646P

CORPO LAMPADA "A"

materiale	vetroresina	
esterno	liscio	
interno	naturale	
colore	bianco	

ROSONE "E"

materiale	metallo
colore	bianco opaco

CAVO ELETTRICO "C"

materiale	PVC	
colore	trasparente	

FUNE DI SOSPENSIONE "F"

materiale	acciaio
-----------	---------

DISPOSITIVO ELETTRICO

portalampane	E27
sorgente luminosa	max 1x70w
classe energetica	da E a A++

PACKAGING

n° colli	1
peso netto/kg	2
peso lordo/kg	3,6
imballo/cm	43x43x82

EMISSIONE LUMINOSA

unidirezionale

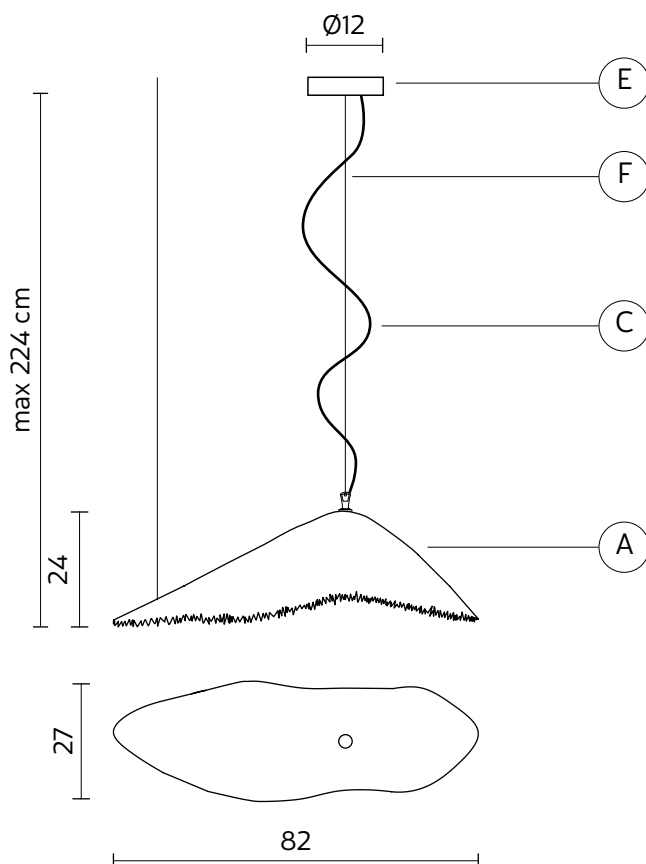

CERTIFICAZIONI

IEC	60598-1:2008
EN	60598-1:2008 + A11:2009



grado di protezione lampadina	IP20 non inclusa
-------------------------------	---------------------

COLLEZIONE

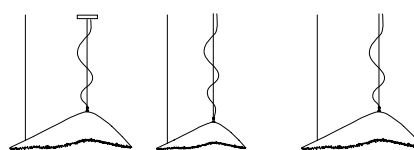

SE647G

SE646P-EXT

SE647G-EXT

MOBY DICK

SE646P
SE647G

220-240 V.
max 1x70W - E27 (a)
max 1x100W - E27 (b)

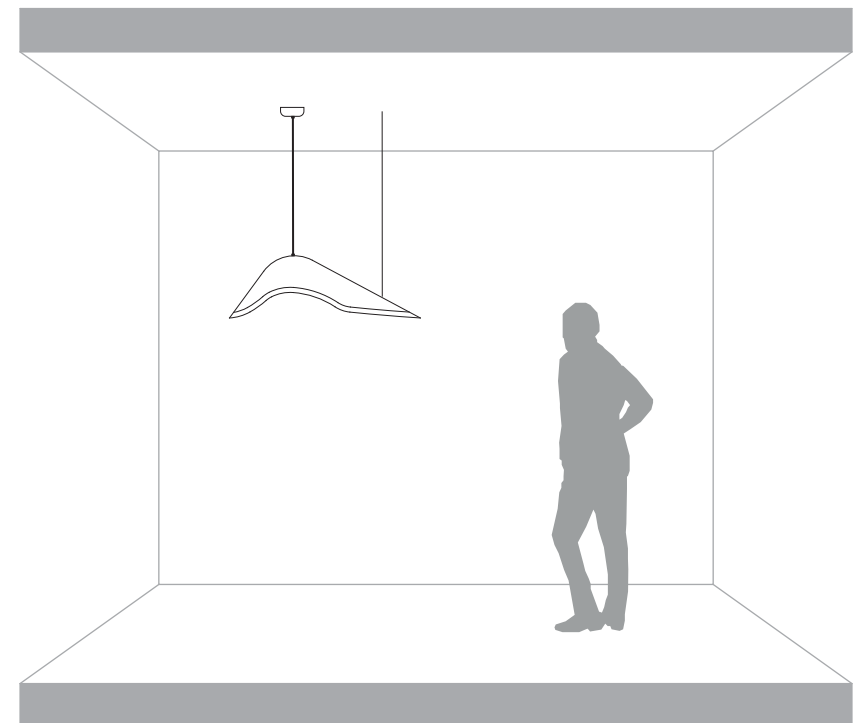
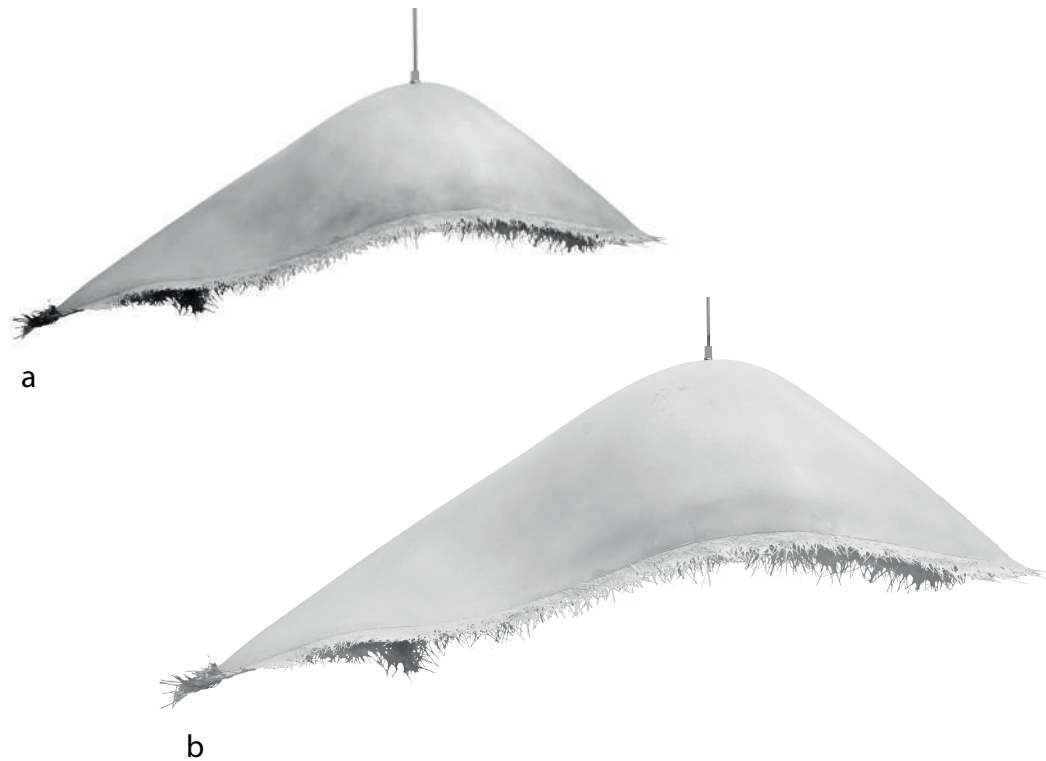

Karman srl

Via A. Grandi, San Martino del piano, 61034 Fossombrone (PU), Italy - p.iva 02175640412 tel +39 0721 71 5042 r.a fax +39 0721 716640 - www.karmanitalia.it

C - 01

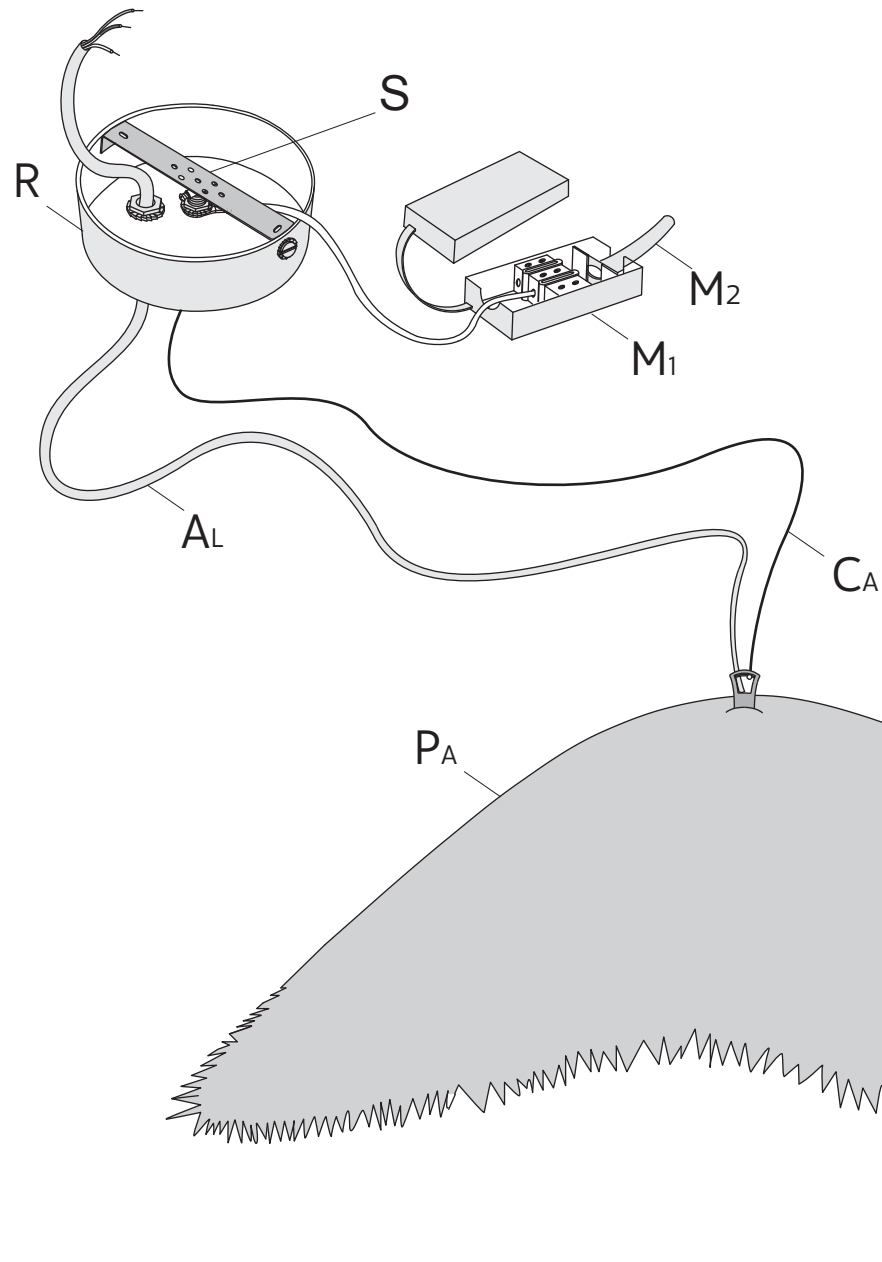

2x **F**

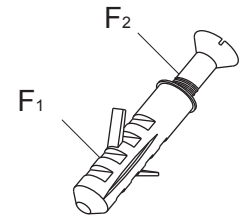

1x **B**

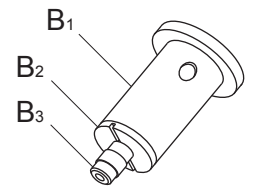

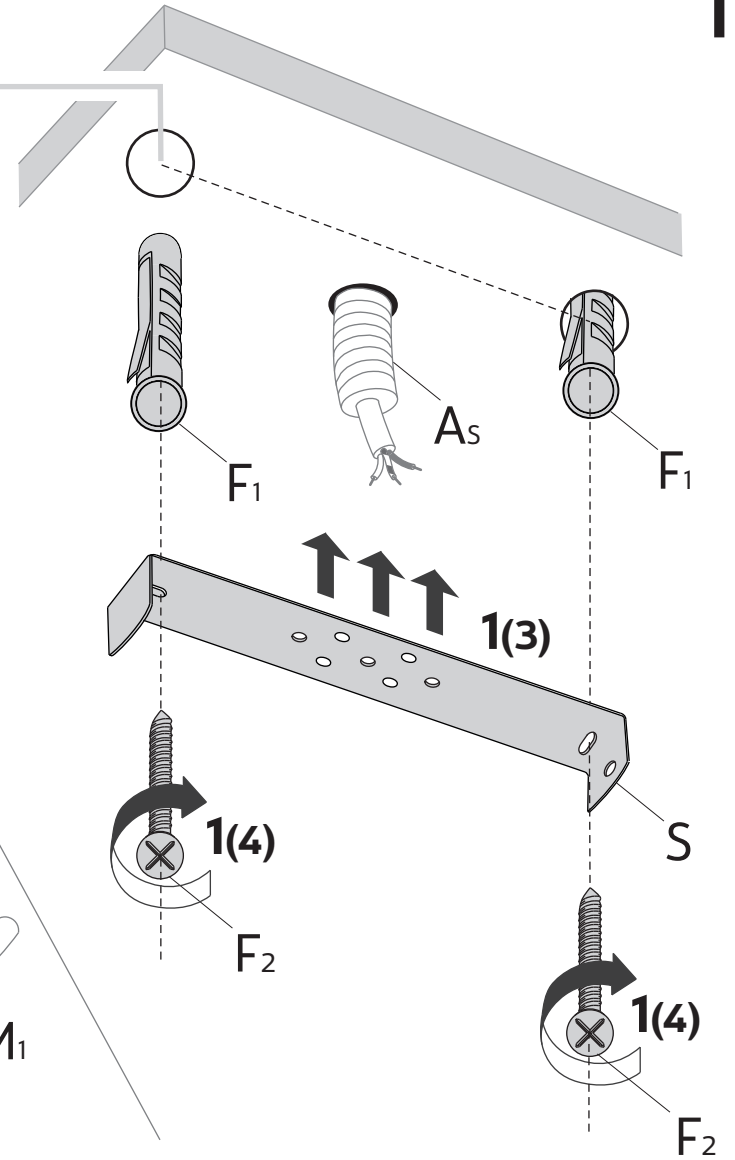
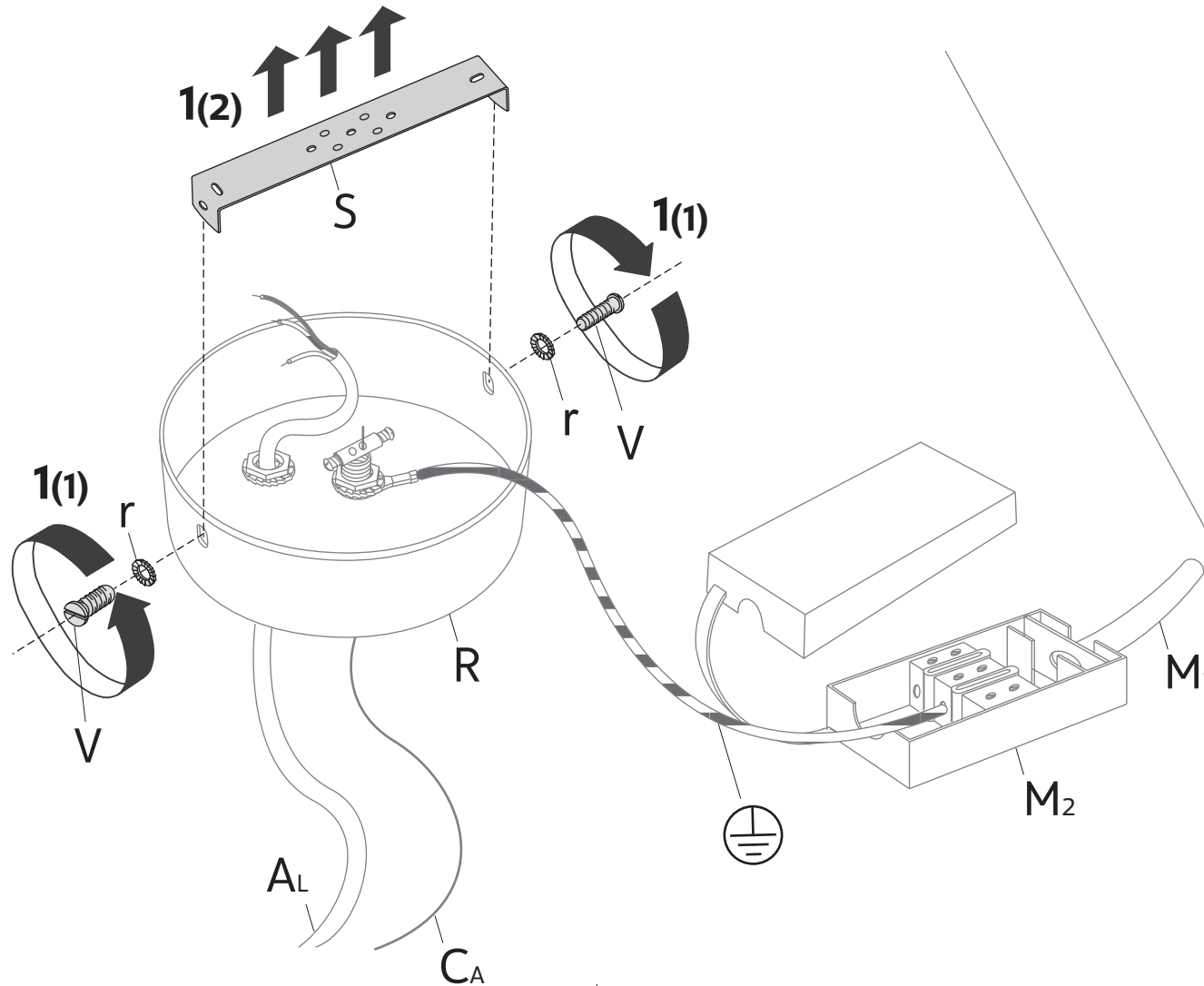
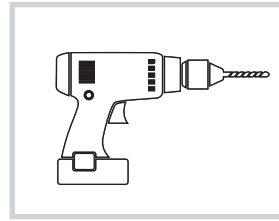
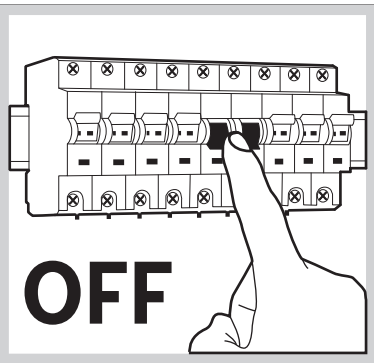

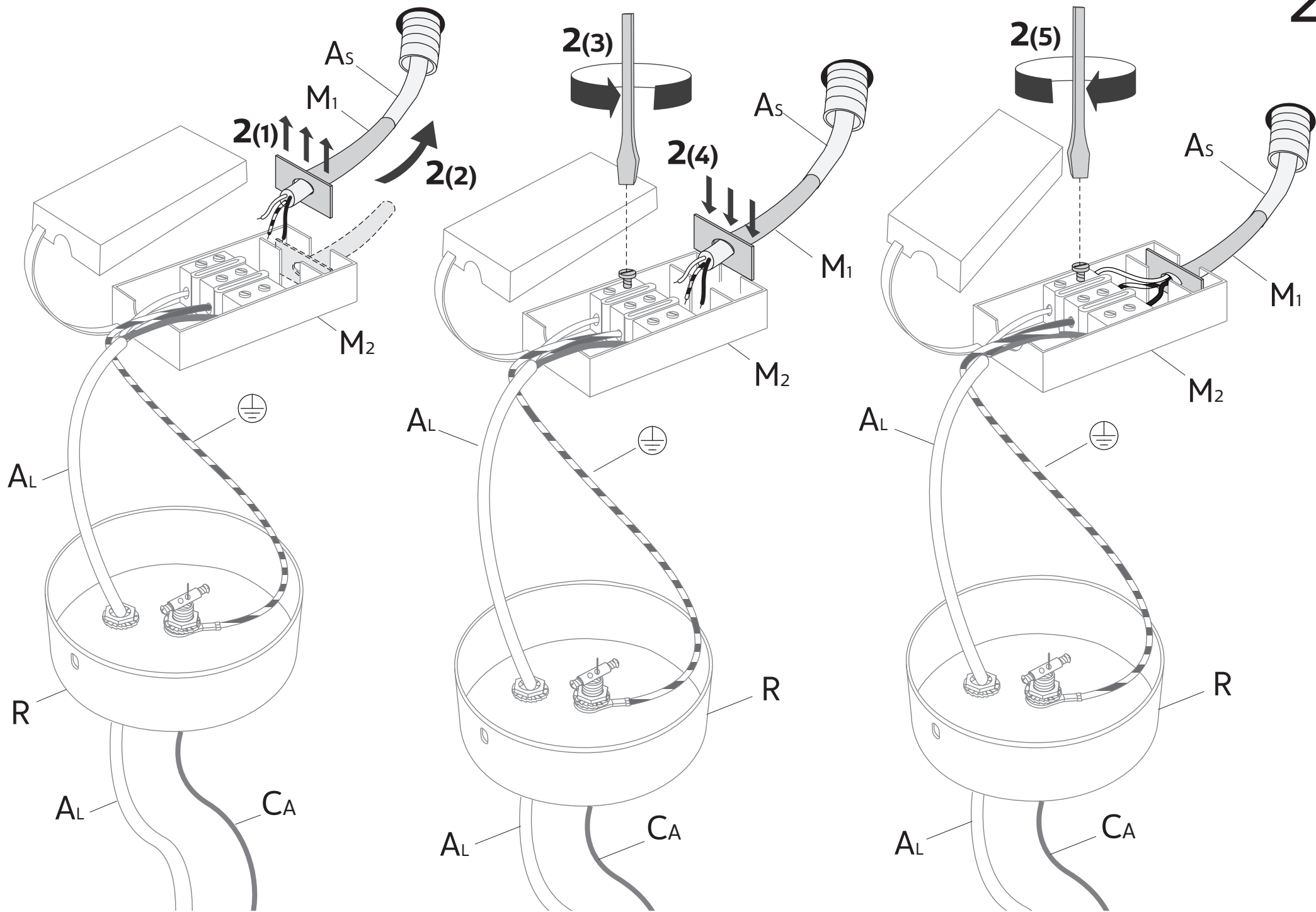

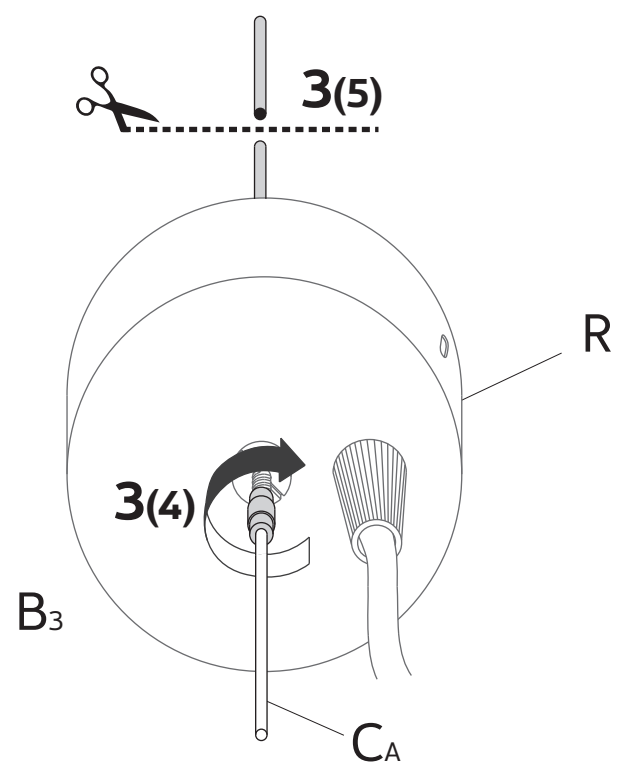
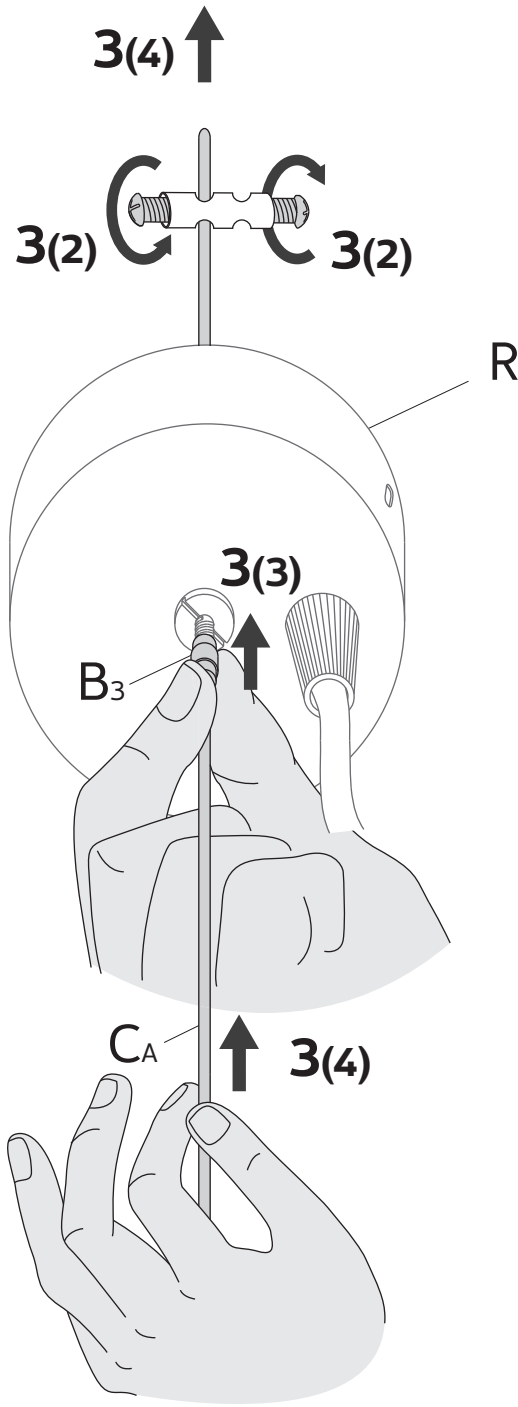
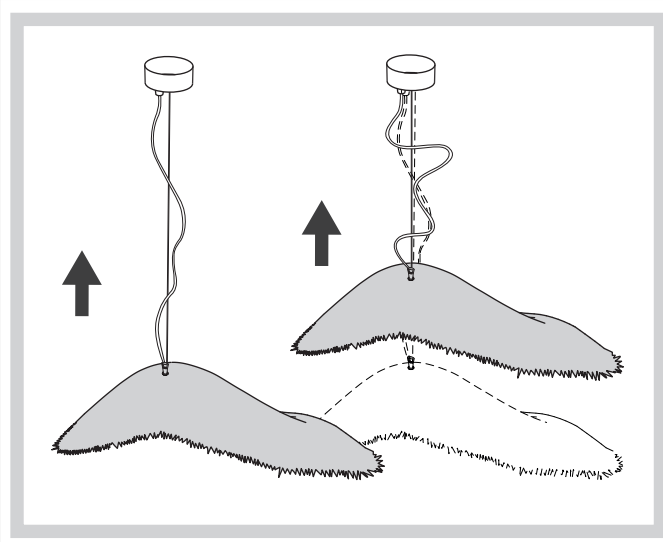

3

